

# Series 2001HSP

## SELF PRIMING ANALYZER SAMPLE PUMP

Designed to meet the demanding requirements of continuous liquid sample delivery

Designed to meet the demanding requirements of continuous duty liquid sampling and chemical feed systems. The 2001HSP utilizes a positive displacement peristaltic pumphead with spring-loaded rollers that provide extended tubing life.



*The unique 2001HSP peristaltic pump operates at low speed which helps extend tubing life.*

One size pumphead accommodates six tubing sizes for flexibility in flow outputs. A wide range of flow outputs can be obtained by simply changing the tubing size.

The sealed, spring-loaded pumphead rollers automatically compensate for minor variations in pump tube wall thickness.

### 2001HSP FEATURES

- Flows from 20 to 648 ml/min (0.3 to 10.3 GPH)
- Totally enclosed NEMA TEFC motor
- Seal-less pumping technology
- Self-priming – suction lifts to 30 ft.
- No check valves – few moving parts
- Stainless steel pumphead
- Dry run capability
- Various long life tubing options available

*The 2001HSP self-priming pump does not require check valves.*

*Liquid stays confined in the pump tubing and never contacts pump parts. Pump requires little maintenance.*

*High lift and a wide range of flow rates make this pump ideal for many applications.*



**ANALYZER SAMPLE PUMPS**

# FLOMOTION 2001HSP ENGINEERING SPECIFICATIONS

## MOTOR

- 1/12 HP 115VAC 60HZ
- TEFC

## MECHANICAL

- Pump weight: 16 lbs.
- Pump Finish: Corrosion resistant epoxy coated.
- Color: Black.

## AGENCY APPROVALS



## TUBING DESCRIPTIONS

- FLOPRENE™ - Thermoplastic elastomer
  - TYGOPRENE XL-60 - PVC based thermoplastic
  - NORPRENE<sup>1</sup> - Thermoplastic elastomer
  - CHEMSURE<sup>2</sup> - Fluoroelastomer
- 1 Registered Trademark of Saint-Gobain Performance Plastics  
2 Registered Trademark of W.L. Gore & Associates

Estimated Pumping Capacity						
Tubing No.	#119	#120	#15	#24	#35 & 121	#36 & 122
Tubing Size	1.6mm bore (1/16")	3.2mm bore (1/8")	4.8mm bore (3/16")	6.4mm bore (1/4")	8mm bore (5/16")	9.6mm bore (3/8")
ml/min @ 45 rpm	20 (0.32 gph)	85 (1.34 gph)	184.5 (2.92 gph)	333 (5.28 gph)	495 (7.85 gph)	648 (10.27 gph)
ml/rev	0.45	1.88	4.1	7.4	11	14.4

\*Actual flow rates may vary

## DIMENSIONS

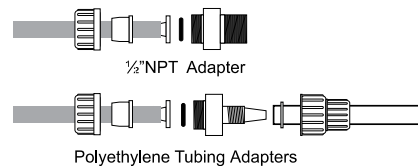
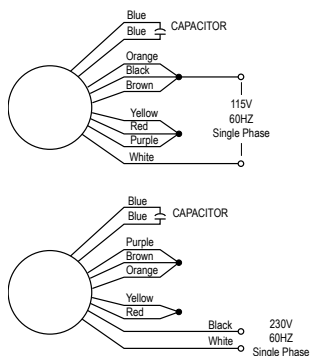
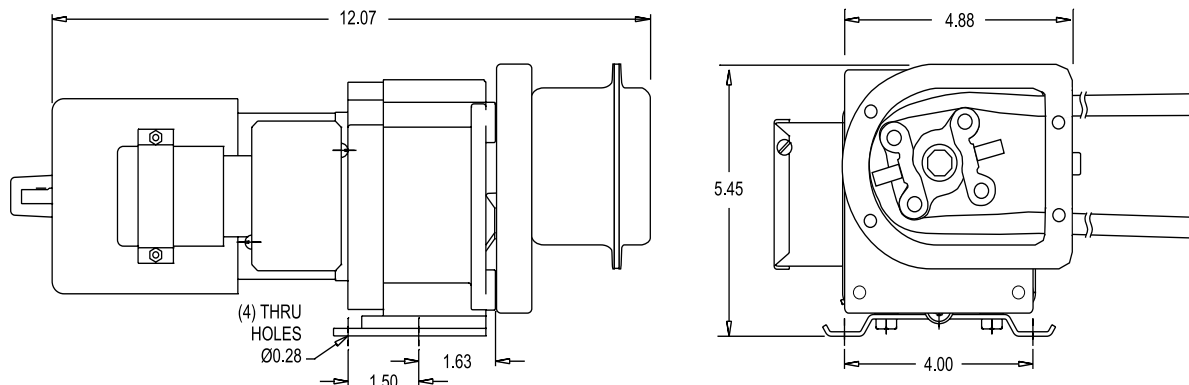

## FLOMOTION SYSTEMS Inc.

165 Creekside Drive, Suite 112

Buffalo NY 14228-2103

Tel: 716-691-3941

Fax: 716-691-1253

Email: [info@flomotionsystems.com](mailto:info@flomotionsystems.com)

[www.flomotionsystems.com](http://www.flomotionsystems.com)

