

MS501

ISOMAG



FLOMOTION
SYSTEMS

MICROFLOW ELECTROMAGNETIC FLOWMETERS

Reliable full-pipe flow measurement with high accuracy,
ease of installation and low operating cost

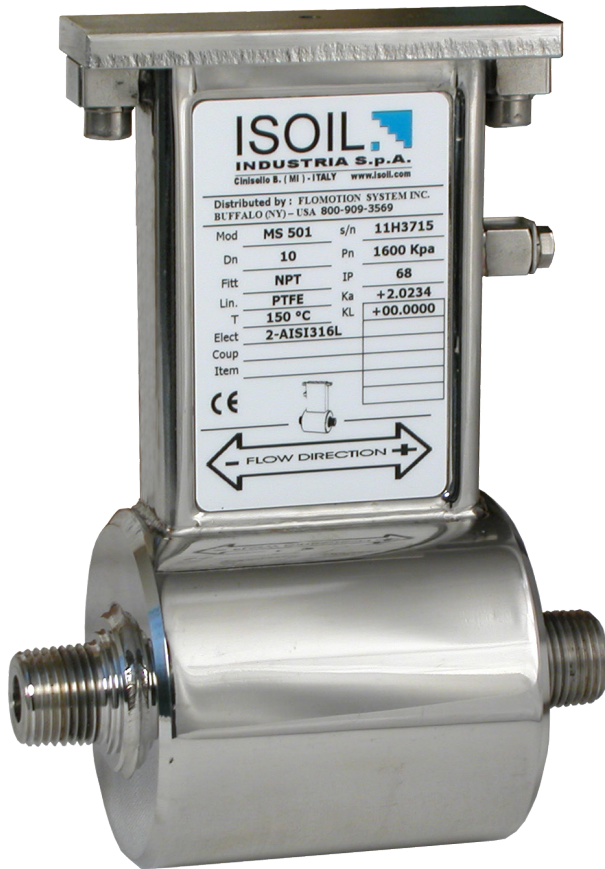

The MS501 comes with a PTFE liner
and local or remote mounted converter.

MS501 FEATURES

- Accuracy to $\pm 0.2\%$ of rate from 1 to 33 ft/sec.
- Five sizes from 1/8" to 3/4" Pipe Diameters.
- Flow ranges from .03 to 49.8 GPM.
- Standard pressure: 230 PSI.
- Volumetric flow rate measurement independent of fluid viscosity, density and temperature.
- No moving parts for zero maintenance.
- Wide range of process connection types; threaded, flanged, tri-clamp or compression.
- Bi-directional flow measurement.
- No pressure drop through sensor.
- Minimal straight pipe run required.
- Every sensor is factory wet-calibrated.

TYPICAL APPLICATIONS

- Syrups
- Milk
- Fruit Juices
- Beer
- Salad Dressings
- Tomato Pastes
- Ketchup
- Yogurt
- Wines
- Jellies
- Preserves
- Ice Cream Mix
- Gravies
- Flavorings
- Vinegar
- Mayonnaise
- Soups
- Whey
- Meat Batters
- Specialty Chemicals
- Polymers
- Adhesives
- Fragrances
- Color & Dyes



The MS501 shown with the ML4F1
High Speed Batching Converter.

ELECTROMAGNETIC FLOWMETER

FLOMOTION MS501 ENGINEERING SPECIFICATIONS

- Accuracy: See relevant converter data sheet
- Repeatability: $\pm 0.1\%$
- Temperature:
 - Process: -4 to 212 °F
 - Ambient: 140 °F
- Pressure: 230 PSI (higher pressures upon request)
- Liner Material: PTFE
- Flow Tube: 304 S.S.
- Body Material: 304 S.S.
- Process Connections & Electrode Material: 316 S.S.*
- Number of Electrodes: 2
- Environmental Rating: NEMA 4X
- Fluid Conductivity: 5 $\mu\text{S/cm}$ (min)

AVAILABLE SIZES AND DIMENSIONS

Size (in.)	1/8"	1/4"	3/8"	1/2"	3/4"
Min Flow Rate (gpm @ 1 ft/sec)	0.034	0.14	0.38	0.85	1.52
Max Flow Rate (gpm @ 33 ft/sec)	1.12	4.49	12.46	28.03	49.84
Weight (lbs.)	4.85	4.85	4.85	4.85	4.85
Length (L below) w/Tri-Clamp Fittings	5.02	5.02	5.02	5.02	5.02
Length (L below) w/NPT Fittings	4.72	4.72	4.72	4.72	4.72
Fittings (NPT)	1/4"	3/8"	1/2"	3/4"	1"

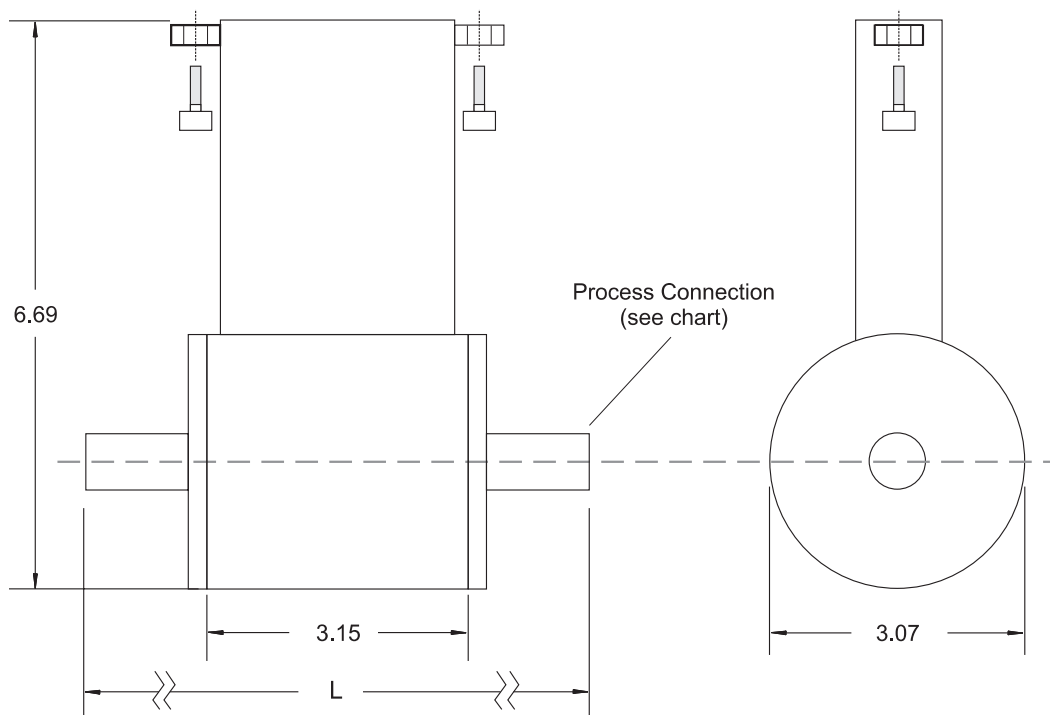

FLOMOTION SYSTEMS Inc.

165 Creekside Drive, Suite 112

Buffalo NY 14228

Tel: 716-691-3941

Fax: 716-691-1253

Email: info@FlomotionSystems.com

www.FlomotionSystems.com

